

EC

- Low Impedance
- Endurance 2000 hours at 105°C
- Comply with the RoHS

SPECIFICATIONS

Category Temperature	-40+105°C								
Voltage Range	6.3-100V.DC								
Capacitance Tolerance	±20%(120Hz,20°C)								
Leakage Current	I≤0.01CV(μA) or 3μA, whichever is greater (2 minutes)								
Dissipation Factor (120hz、20°C)	WV	6.3	10	16	25	35	50	63	100
	tgδ	0.28	0.24	0.20	0.16	0.14	0.12	0.10	0.09
When nominal capacitance is over 1000 μF, tanδ shall be added 0.02 to the list value with increase of every 1000 μF.									
Stability at Low Temperature (120Hz)	WV	6.3	10	16	25	35	50	63	100
	Z _{-25°C} /Z _{+20°C}	5	4	3	2	2	2	2	2
	Z _{-40°C} /Z _{+20°C}	12	10	8	5	4	3	3	3
Endurance	In an environment of +105°C, apply the operating voltage with ripple current for 2000 hours, and after 16 hours of recovery, the product performance meets the following requirements:								
	Capacitance	Within ±20%of initial measured							
	Dissipation Factor	≤200% of initial specified value							
	Leakage Current	≤initial specified value							
Shelf Life	In an environment of +105°C, apply the operating voltage with ripple current for 1000 hours, and after 16 hours of recovery, the product performance meets the following requirements:								
	Capacitance	Within ±20%of initial							
	Dissipation Factor	≤200% of initial specified							
	Leakage Current	≤200% of initial specified							

DRAWING & DIMENSIONS (Unit: mm)

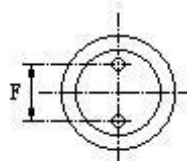
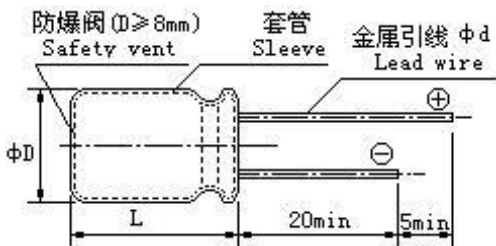

ΦD	5	6.3	8	10	13	16	18
F±0.5	2.0	2.5	3.5	5.0	5.0	7.5	7.5
Φd±0.05	0.5	0.5	0.5	0.6	0.6	0.8	0.8
L	(L<20) ±1.5				(L≥20) ±2.0		
D	(D<20) ±0.5				(D≥20) ±1.0		

REQUENCY COEFFICIENT OF ALLOWABLE RIPPLE CURRENT

Capacitance(μF)	Frequency(Hz)	50	120	1K	10K	100K
	Coefficient					
Capacitance<10		0.65	1.00	1.75	2.30	2.50
10≤Capacitance<100		0.75	1.00	1.50	1.75	1.80
100≤Capacitance<1000		0.80	1.00	1.30	1.40	1.50
Capacitance≥1000		0.85	1.00	1.05	1.08	1.08

EC

NOMINAL CAPACITANCE, RATED VOLTAGE & DIMENSIONS

	6.3V (0J)			10V (1A)		
	Dimensions (mm)	Ripple Current (mA)	Part Number	Dimensions (mm)	Ripple Current (mA)	Part Number
22				5X11	46	EC1A220M0511BBH00000
33	5X11	54	EC0J330M0511BBH00000	5X11	57	EC1A330M0511BBH00000
47	5X11	64	EC0J470M0511BBH00000	5X11	68	EC1A470M0511BBH00000
100	5X11	94	EC0J101M0511BBH00000	5X11	100	EC1A101M0511BBH00000
220	5X11	140	EC0J221M0511BBH00000	6.3X12	170	EC1A221M6L12CBH00000
330	6.3X12	190	EC0J331M6L12CBH00000	6.3X12	200	EC1A331M6L12CBH00000
470	6.3X12	230	EC0J471M6L12CBH00000	8X12	250	EC1A471M0812DBH00000
1000	8X12	380	EC0J102M0812DBH00000	10X13	460	EC1A102M1013EBH00000
2200	10X20	710	EC0J222M1020EBH00000	10X20	760	EC1A222M1020EBH00000
3300	10X20	840	EC0J332M1020EBH00000	13X20	1000	EC1A332M1320EBH00000
4700	13X20	1090	EC0J472M1320EBH00000	13X25	1260	EC1A472M1325EBH00000
6800	13X25	1350	EC0J682M1325EBH00000	16X25	1570	EC1A682M1625FBH00000
10000	16X25	1650	EC0J103M1625FBH00000	16X35	1890	EC1A103M1635FBH00000
15000	16X35	2010	EC0J153M1635FBH00000	18X35	2180	EC1A153M1835FBH00000
22000	18X40	2350	EC0J223M1840FBH00000			

	16V (1C)			25V (1E)		
	Dimensions (mm)	Ripple Current (mA)	Part Number	Dimensions (mm)	Ripple Current (mA)	Part Number
10	5X11	34	EC1C100M0511BBH00000	5X11	36	EC1E100M0511BBH00000
22	5X11	51	EC1C220M0511BBH00000	5X11	54	EC1E220M0511BBH00000
33	5X11	63	EC1C330M0511BBH00000	5X11	67	EC1E330M0511BBH00000
47	5X11	75	EC1C470M0511BBH00000	5X11	80	EC1E470M0511BBH00000
100	5X11	110	EC1C101M0511BBH00000	6.3X12	130	EC1E101M6L12CBH00000
220	6.3X12	180	EC1C221M6L12CBH00000	8X12	230	EC1E221M0812DBH00000
330	8X12	260	EC1C331M0812DBH00000	8X12	310	EC1E331M0812DBH00000
470	8X12	310	EC1C471M0812DBH00000	10X13	380	EC1E471M1013EBH00000
1000	10X16	560	EC1C102M1016EBH00000	10X20	680	EC1E102M1020EBH00000
2200	13X20	920	EC1C222M1320EBH00000	13X25	1090	EC1E222M1325EBH00000
3300	13X25	1170	EC1C332M1325EBH00000	16X25	1400	EC1E332M1625FBH00000
4700	16X25	1480	EC1C472M1625FBH00000	16X30	1710	EC1E472M1630FBH00000
6800	16X30	1780	EC1C682M1630FBH00000	18X35	2040	EC1E682M1835FBH00000
10000	18X35	2060	EC1C103M1835FBH00000			

Rated ripple current: (105°C, 120Hz)

EC

NOMINAL CAPACITANCE, RATED VOLTAGE & DIMENSIONS

	35V (1V)			50V (1H)		
	Dimensions (mm)	Ripple Current (mA)	Part Number	Dimensions (mm)	Ripple Current (mA)	Part Number
1				5X11	13	EC1H1R0M0511BBH00000
2.2				5X11	20	EC1H2R2M0511BBH00000
3.3				5X11	25	EC1H3R3M0511BBH00000
4.7	5X11	28	EC1V4R7M0511BBH00000	5X11	30	EC1H4R7M0511BBH00000
10	5X11	41	EC1V100M0511BBH00000	5X11	40	EC1H100M0511BBH00000
22	5X11	61	EC1V220M0511BBH00000	5X11	65	EC1H220M0511BBH00000
33	5X11	75	EC1V330M0511BBH00000	6.3X12	90	EC1H330M6L12CBH00000
47	5X11	90	EC1V470M0511BBH00000	6.3X12	110	EC1H470M6L12CBH00000
100	6.3X12	150	EC1V101M6L12CBH00000	8X12	180	EC1H101M0812DBH00000
220	8X12	270	EC1V221M0812DBH00000	10X13	300	EC1H221M1013EBH00000
330	10X13	350	EC1V331M1013EBH00000	10X16	410	EC1H331M1016EBH00000
470	10X16	460	EC1V471M1016EBH00000	10X20	530	EC1H471M1020EBH00000
1000	13X20	810	EC1V102M1320EBH00000	13X25	950	EC1H102M1325EBH00000
2200	16X25	1260	EC1V222M1625FBH00000	16X35	1470	EC1H222M1635FBH00000
3300	16X35	1610	EC1V332M1635FBH00000	18X35	1770	EC1H332M1835FBH00000
4700	18X35	1910	EC1V472M1835FBH00000			

	63V (1J)			100V (2A)		
	Dimensions (mm)	Ripple Current (mA)	Part Number	Dimensions (mm)	Ripple Current (mA)	Part Number
1				5X11	15	EC2A1R0M0511BBH00000
2.2				5X11	21	EC2A2R2M0511BBH00000
3.3				5X11	29	EC2A3R3M0511BBH00000
4.7				5X11	32	EC2A4R7M0511BBH00000
10	5X11	46	EC1J100M0511BBH00000	6.3X12	54	EC2A100M6L12CBH00000
22	5X11	71	EC1J220M0511BBH00000	8X12	93	EC2A220M0812DBH00000
33	6.3X12	100	EC1J330M6L12CBH00000	8X12	130	EC2A330M0812DBH00000
47	6.3X12	120	EC1J470M6L12CBH00000	10X13	165	EC2A470M1013EBH00000
100	10X13	215	EC1J101M1013EBH00000	10X20	265	EC2A101M1020EBH00000
220	10X16	335	EC1J221M1016EBH00000	13X25	440	EC2A221M1325EBH00000
330	10X20	510	EC1J331M1020EBH00000	16X25	540	EC2A331M1625FBH00000
470	13X20	640	EC1J471M1320EBH00000	16X30	715	EC2A471M1630FBH00000
1000	16X25	930	EC1J102M1625FBH00000	18X40	985	EC2A102M1840FBH00000

Rated ripple current: (105°C, 120Hz)