

## SM

- Small size, height 7mm
- Endurance 2000 hours at 105°C
- Comply with the RoHS

## SPECIFICATIONS

Category Temperature	-40+105°C						
Voltage Range	6.3-50V.DC						
Capacitance Tolerance	±20%(120Hz,20°C)						
Leakage Current	I≤0.01CV(μA) or 3μA, whichever is greater (2 minutes)						
Dissipation Factor (120hz、20°C)	WV	6.3	10	16	25	35	50
	tgδ	0.26	0.22	0.18	0.16	0.14	0.12
When nominal capacitance is over 1000 μF, tanδ shall be added 0.02 to the list value with increase of every 1000 μF.							
Stability at Low Temperature (120Hz)	WV	6.3	10	16	25	35	50
	Z <sub>-25°C</sub> /Z <sub>+20°C</sub>	4	3	2	2	2	2
	Z <sub>-40°C</sub> /Z <sub>+20°C</sub>	8	6	4	3	3	3
Endurance	In an environment of +105°C, apply the operating voltage with ripple current for 2000 hours, and after 16 hours of recovery, the product performance meets the following requirements:						
	Capacitance	Within ±20%of initial measured					
	Dissipation Factor	≤200% of initial specified value					
	Leakage Current	≤initial specified value					
Shelf Life	In an environment of +105°C, apply the operating voltage with ripple current for 1000 hours, and after 16 hours of recovery, the product performance meets the following requirements:						
	Capacitance	Within ±20%of initial measured					
	Dissipation Factor	≤200% of initial specified value					
	Leakage Current	≤200% of initial specified value					

## DRAWING & DIMENSIONS (Unit: mm)

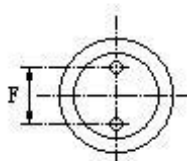
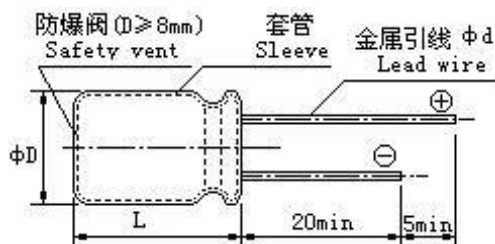

ΦD	4	5	6.3	8
F±0.5	1.5	2.0	2.5	3.5
Φd±0.05	0.45	0.50	0.50	0.50
L	±1.5			
D	±0.5			

## REQUENCY COEFFICIENT OF ALLOWABLE RIPPLE CURRENT

Capacitance(μF) \ Frequency(Hz)	Coefficient			
	50	120	1K	≥10K
Capacitance < 68	0.75	1.00	1.57	2.00
68 ≤ Capacitance < 470	0.80	1.00	1.34	1.50

## SM

### NOMINAL CAPACITANCE, RATED VOLTAGE & DIMENSIONS

	6.3V (0J)			10V (1A)			16V (1C)		
	Dimensions (mm)	Ripple Current (mA)	Part Number	Dimensions (mm)	Ripple Current (mA)	Part Number	Dimensions (mm)	Ripple Current (mA)	Part Number
10							4X7	29	SM1C100M0407ABH00000
22	4X7	34	SM0J220M0407ABH00000	4X7	34	SM1A220M0407ABH00000	4X7	38	SM1C220M0407ABH00000
33	4X7	37	SM0J330M0407ABH00000	4X7	40	SM1A330M0407ABH00000	5X7	50	SM1C330M0507BBH00000
47	4X7	44	SM0J470M0407ABH00000	5X7	50	SM1A470M0507BBH00000	5X7	60	SM1C470M0507BBH00000
100	5X7	67	SM0J101M0507BBH00000	5X7	72	SM1A101M0507BBH00000	6.3X7	92	SM1C101M6L07CBH00000
				6.3X7	83	SM1A101M6L07CBH00000	8X7	106	SM1C101M0807DBH00000
220	6.3X7	112	SM0J221M6L07CBH00000	8X7	140	SM1A221M0807DBH00000			
330	8X7	158	SM0J331M0807DBH00000						

	25V (1E)			35V (1V)			50V (1H)		
	Dimensions (mm)	Ripple Current (mA)	Part Number	Dimensions (mm)	Ripple Current (mA)	Part Number	Dimensions (mm)	Ripple Current (mA)	Part Number
3.3							4X7	24	SM1H3R3M0407ABH00000
4.7				4X7	24	SM1V4R7M0407ABH00000	5X7	29	SM1H4R7M0507BBH00000
10	4X7	29	SM1E100M0407ABH00000	5X7	36	SM1V100M0507BBH00000	5X7	38	SM1H100M0507BBH00000
							6.3X7	44	SM1H100M6L07CBH00000
22	5X7	45	SM1E220M0507BBH00000	6.3X7	57	SM1V220M6L07CBH00000	8X7	65	SM1H220M0807DBH00000
33	5X7	55	SM1E330M0507BBH00000	6.3X7	62	SM1V330M6L07CBH00000			
47	6.3X7	67	SM1E470M6L07CBH00000	6.3X7	74	SM1V470M6L07CBH00000			
100	6.3X7	97	SM1E101M6L07CBH00000						

Rated ripple current: (105°C, 120Hz)